

Prime Corporate Space with Outstanding Features



A six-storey industrial building with a ground level carpark.

Zoning	B1 Industrial
Typical Floor Plate	130,000 sq ft
Net Lettable Area	37,000 sqft
Lifts	<ul style="list-style-type: none"> • 18 passenger lifts (1,350 kg) and 2 passenger lifts (630kg) • 15 goods lifts • 8 fire lifts
Carpark	<ul style="list-style-type: none"> • 560 lots
Lorry & Loading / Unloading	<ul style="list-style-type: none"> • 35 lorry lots with 14 dock levellers on the loading and unloading bay
Accessibility	<ul style="list-style-type: none"> • Located opposite Lorong Chuan MRT along the Circle Line • Accessible via CTE, PIE and KPE
Amenities	<ul style="list-style-type: none"> • Amenities include F&B, supermarket and child care facilities

Estate Agent License No
L3008887C

**Moving Ahead With
Corporate Visions**

Ideal for MNCs

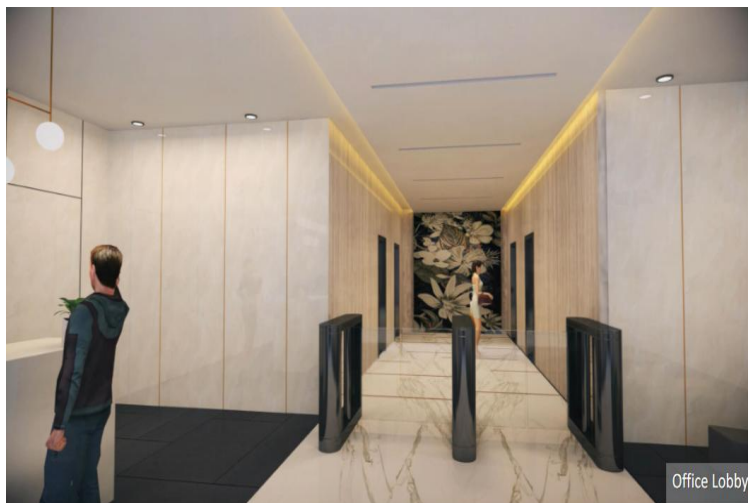

Corporate Visions Pte Ltd Estate Agent Licence No L3008887C Tel : 65 6733 2911 Fax : 65 6733 6786 www.corporatevision.sg

The information contained hereby is subject to change and cannot form part of an offer or contract. While every reasonable care has been taken in providing this information, the owner or its agent cannot be held responsible for any damage or loss suffered as a result of any inaccuracies in this documents. All interested parties shall make enquiries to satisfy themselves of any the information. Copyright@2012 .All rights reserved

Estate Agent License No
L3008887C

Moving Ahead With
Corporate Visions